

# FITTINGS



**E-Line Fittings**



### E-LINE FITTINGS....

E-Line Fittings have a male and female interface construction to ensure rigidity of your system.

VNE offers E-Line Fittings in sizes 1" through 6" in T304 and T316L material. VNE offers Polished ID and OD Fittings for immediate shipment. Other polished combinations may be ordered.

Gaskets for E-Line Fittings are available in several different materials, Buna-N, EPDM, Teflon®, Silicone, and Viton.

### E-LINE FITTING SPECIFICATIONS....

**Size Range:** 1" OD through 6" OD

**Materials:** T304  
T316L

**Finish:** No. 7 - ID & OD  
No. 5 - OD only  
No. 3 - ID only  
No. 1 - unpolished

### ORDERING SPECIFICATIONS....

**Specify:**

- Quantity
- Product description or Part No.
- Size
- Material Type
- Polish Requirements

### LIMITED WARRANTY....

VNE Corporation products are warranted to be free from defects in material and workmanship for a period of one year from the date of shipment. Any product that proves to be defective shall be repaired or replaced at the option of VNE, providing it has been used as recommended and in strict accordance with recognized piping practices, and that has not been subject to extraordinary service, such as encountered under severe corrosive or abrasive conditions.

VNE makes no warranties, express or implied, other than those listed above.

VNE shall not be liable for any consequential, indirect, incidental or contingent damages.

### VNE CORPORATION

P.O. Box 1698 • 1149 Barberry Drive • Janesville, WI 53547

TEL: 608-756-4930 • FAX: 608-756-3643 • 1-800-356-1111 • Web site: [vnestainless.com](http://vnestainless.com)

# INDUSTRY CROSS - REFERENCE

STAINLESS STEEL FITTINGS  
PRODUCT CATALOG

## E-LINE TYPE

VNE	ROBERT JAMES	ANDRON	WAUKESHA	G & H
E2CI	RJ2CZ	----	2CI	HDI-2C
E2FI	RJ2FZ	----	2FI	HDI-2F
E2EI	----	----	2EI	HDI-2E
E2KI	RJ2KZ	----	2KI	HDI-2K
E2PI	RJ2PZ	----	2PI	HDI-2P
E7I	RJ7Z	----	7I	HDI-7
E7AI	RJ7AZ	----	7AI	----
E7EI	RJ7EZ	----	7EI	----
E7BI	RJ7BZ	----	7BI	----
E9I	RJ9Z	----	9I	----
E13IS	RJ13ZS	----	13IS	HDI-13-UD
E13IU	RJ13Z	----	13IU	HDI-13-U
E14WI	RJ14WZ	AY14WI	14WI	14WH
E15WI	RJ15WZ	AY15WI	15WI	15WH
E14WLI	RJ14WLZ	AY14WLI	14WLI	14WLH
E15WLI	RJ15WLZ	AY15WLI	15WLI	15WLH
E14HRI	RJ14HRZ	AY14AHR	14HRI	----
E14HTI	RJ14HTZ	AY14AHT	14HTI	----
E15HRI	RJ15HRZ	AY15AHR	15HRI	----
E15HTI	RJ15HTZ	AY15AHT	15HTI	----
E17-14I-15I	RJ17-14Z-15Z	----	17-14I-15I	----
E17-15I-15I	RJ17-15Z-15Z	----	17-15I-15I	----
E17-14I-14I	RJ17-14Z-14Z	----	17-14I-14I	----
E17-14I-14	RJ17-14Z-14	----	17-14I-14	----
E17-14I-14MP	RJ17-14Z-14MP	----	17-14I-14MP	----
E17-14I-15	RJ17-14Z-15	----	17-14I-15	----
E17-15I-14	RJ17-15Z-14	----	17-15I-14	----
E17-15I-15	RJ17-15Z-15	----	17-15I-15I	----
E17-15I-14MP	RJ17-15Z-14MP	----	17-15I-14MP	----
E21I-14I	RJ21-14Z	----	21FI-14I	----
E21I-15I	RJ21-15Z	----	21F1-15I	----
E22I-14I	RJ22-14Z	----	22FI-14I	----
E22I-15I	RJ22-15Z	----	22FI-15I	----
E16AI-14I	RJ16AZ-14Z	AY16AI-14I	16AI-14I	HDI-16A-14
E16AI-15I	RJ16AZ-15Z	AY16AI-15I	16AI-15I	HDI-16A-15
E31I-14I	RJ31Z-14Z	----	31I-14FI	HDI-31-14F
E31I-15I	RJ31Z-15Z	----	31I-15FI	HDI-31-15F
E31I-15I-14I	RJ31Z-15Z-14Z	----	----	----
E31I-15I-15I	RJ31Z-15Z-15Z	----	----	----
E32I-14I	RJ32Z-14Z	----	32I-14FI	HDI-32-14F
E32I-15I	RJ32Z-15Z	----	32I-15FI	HDI-32-15F

# E-LINE FITTINGS

STAINLESS STEEL FITTINGS  
PRODUCT CATALOG

## E2CI - 90° ELBOW FEMALE X FEMALE

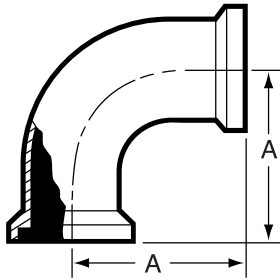

Size Tube OD	A
1	2.281
1 1/2	3.182
2	4.031
2 1/2	4.906
3	5.718
4	7.343
6	10.125

## E2FI - 90° ELBOW MALE X FEMALE

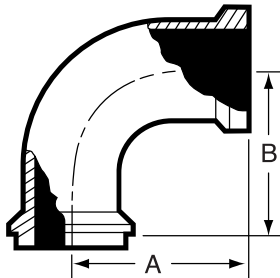

Size Tube OD	A	B
1	2.281	2.093
1 1/2	3.187	3.000
2	4.031	3.781
2 1/2	4.906	4.593
3	5.718	5.406
4	7.343	7.031
6	10.125	9.187

## E2EI - 90° ELBOW MALE X MALE

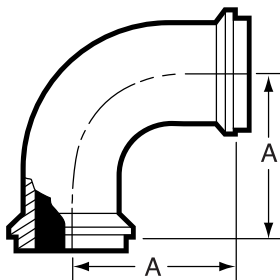

Size Tube OD	A
1	2.093
1 1/2	3.000
2	3.781
2 1/2	4.593
3	5.406
4	7.031
6	9.187

## E2KI - 45° ELBOW FEMALE X FEMALE

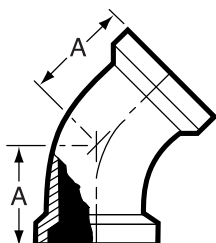

Size Tube OD	A
1	1.406
1 1/2	1.875
2	2.281
2 1/2	2.718
3	3.093
4	3.843
6	4.875

# E-LINE FITTINGS

## STAINLESS STEEL FITTINGS PRODUCT CATALOG

### E2PI - 45° ELBOW FEMALE X MALE

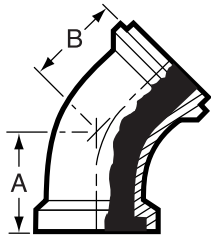

Size Tube OD	A	B
1	1.406	1.218
1 1/2	1.875	1.687
2	2.281	2.031
2 1/2	2.718	2.406
3	3.093	2.781
4	3.843	3.531
6	4.875	4.562

### E2HI - 45° ELBOW MALE X MALE

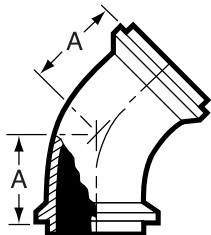

Size Tube OD	A
1	1.218
1 1/2	1.687
2	2.031
2 1/2	2.406
3	2.781
4	3.531
6	4.562

### E71 - TEE ALL ENDS FEMALE

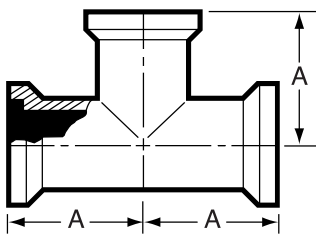

Size Tube OD	A
1	1.875
1 1/2	2.593
2	3.062
2 1/2	3.468
3	3.812
4	4.968
6	6.750

### E7AI - TEE FEMALE X FEMALE X MALE

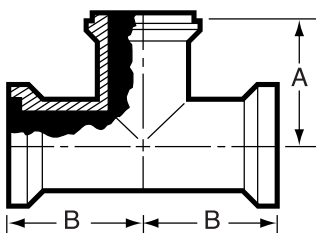

Size Tube OD	A	B
1	1.687	1.875
1 1/2	2.406	2.593
2	2.812	3.062
2 1/2	3.156	3.468
3	3.500	3.812
4	4.656	4.968
6	6.437	6.750

# E-LINE FITTINGS

## STAINLESS STEEL FITTINGS PRODUCT CATALOG

### E7BI - TEE MALE X FEMALE X FEMALE

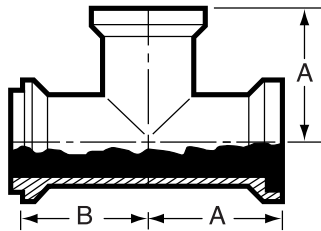

Size Tube OD	A	B
1	1.875	1.687
1 1/2	2.593	2.406
2	3.062	2.812
2 1/2	3.468	3.156
3	3.812	3.500
4	4.968	4.656
6	6.750	6.437

### E7EI - TEE MALE X MALE X FEMALE

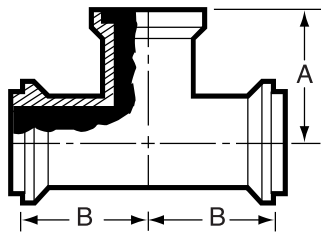

Size Tube OD	A	B
1	1.875	1.687
1 1/2	2.593	2.406
2	3.062	2.812
2 1/2	3.468	3.156
3	3.812	3.500
4	4.968	4.656
6	6.750	6.437

### E7HI - TEE ALL ENDS MALE

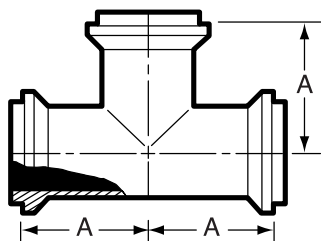

Size Tube OD	A
1	1.687
1 1/2	2.406
2	2.812
2 1/2	3.156
3	3.500
4	4.656
6	6.437

### E7RI - REDUCING TEE ALL ENDS FEMALE

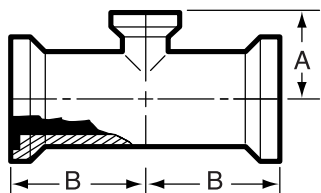

Size Tube OD	A	B
1 1/2 x 1	2.156	2.593
2 x 1	3.093	4.031
2 x 1 1/2	2.718	3.062
2 1/2 x 1 1/2	4.156	4.000
2 1/2 x 2	3.312	3.500
3 x 2	3.562	3.812
3 x 2 1/2	3.750	3.812
4 x 2	5.031	5.218
4 x 2 1/2	4.906	5.218
4 x 3	4 3/84 29/32	5.218
6 x 3	6.843	6.750
6 x 4	6.968	6.750

# E-LINE FITTINGS

## STAINLESS STEEL FITTINGS PRODUCT CATALOG

### E9I - CROSS ALL ENDS FEMALE

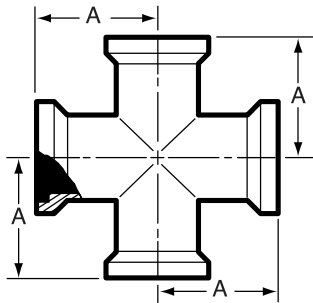

Size Tube OD	A
1	1.875
1 1/2	2.593
2	3.062
2 1/2	3.468
3	3.812
4	4.968
6	6.750

### E14WI - SHORT MALE WELDING FERRULE

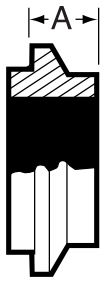

Size Tube OD	A
1	0.593
1 1/2	0.750
2	0.781
2 1/2	0.843
3	0.906
4	1.031
6	0.812

### E14WLI - LONG MALE WELDING FERRULE

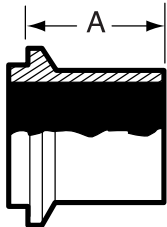

Size Tube OD	A
1	1.563
1 1/2	1.843
2	2.062
2 1/2	2.187
3	2.375
4	2.687
6	3.812

### E15WI - SHORT FEMALE WELDING FERRULE



Size Tube OD	A
1	0.781
1 1/2	0.937
2	1.031
2 1/2	1.156
3	1.218
4	1.343
6	1.125

# E-LINE FITTINGS

## STAINLESS STEEL FITTINGS PRODUCT CATALOG

### E15WLI - LONG FEMALE WELDING FERRULE

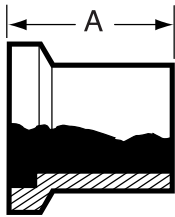

Size Tube OD	A
1	1.750
1 1/2	2.031
2	2.312
2 1/2	2.500
3	2.687
4	3
6	4

### E14HRI - MALE RUBBER HOSE ADAPTER

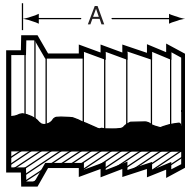

Size Tube OD	A
1	3.562
1 1/2	3.750
2	3.750
2 1/2	3.812
3	3.875
4	4.062
6	8.812

### E14HTI - MALE TYGON HOSE ADAPTER

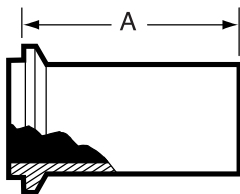

Size Tube OD	A
1	4.062
1 1/2	4.281
2	4.500
2 1/2	4.812
3	5.062
4	5.187

### E15HRI - FEMALE RUBBER HOSE ADAPTER

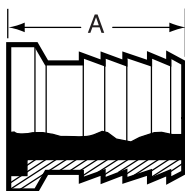

Size Tube OD	A
1	3.750
1 1/2	3.937
2	4.062
2 1/2	4.125
3	4.187
4	4.375
6	9.125



# E-LINE FITTINGS

## STAINLESS STEEL FITTINGS PRODUCT CATALOG

### E15HTI - FEMALE TYGON HOSE ADAPTER

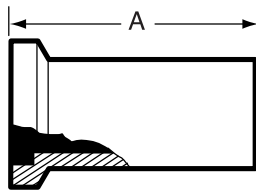

Size Tube OD	A
1	4.250
1 1/2	4.468
2	4.750
2 1/2	5.125
3	5.375
4	5.500

### E14WHI - MALE WELD FERRULE

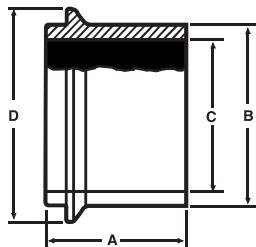

Size Tube OD	A	B	C	D
1	1.625	1.160	0.870	2.000
1 1/2	1.625	1.687	1.370	2.008
2	1.750	2.250	1.870	2.648
2 1/2	1.750	2.708	2.370	3.317
3	1.812	3.313	2.870	3.868
4	2.125	4.250	3.834	4.882

### E15WHI - FEMALE WELD FERRULE

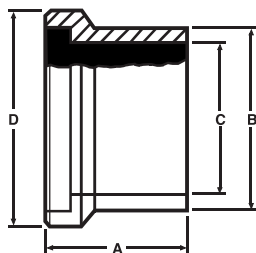

Size Tube OD	A	B	C	D
1	1.625	1.160	0.870	2.000
1 1/2	1.625	1.687	1.370	2.008
2	1.750	2.250	1.870	2.648
2 1/2	1.750	2.708	2.370	3.317
3	1.812	3.313	2.870	3.868
4	2.125	4.250	3.834	4.882

### E17-14I-14I - ADAPTER BOTH ENDS MALE

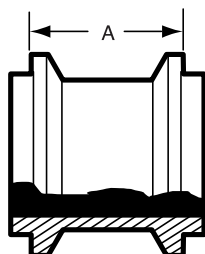

Size Tube OD	A
1	1.187
1 1/2	1.500
2	1.562
2 1/2	1.687
3	1.812
4	2.062
6	1.625

# E-LINE FITTINGS

STAINLESS STEEL FITTINGS  
PRODUCT CATALOG

## E17-14I-15I - ADAPTER MALE X FEMALE

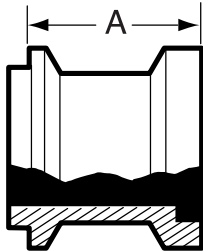

Size Tube OD	A
1	1.375
1 1/2	1.687
2	1.812
2 1/2	1.937
3	2.125
4	2.375
6	1.937

## E17-15I-15I - ADAPTER BOTH ENDS FEMALE

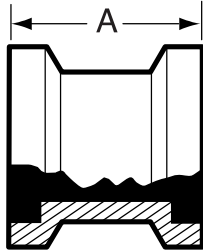

Size Tube OD	A
1	1.562
1 1/2	1.875
2	2.062
2 1/2	2.312
3	2.437
4	2.687
6	2.250

## E17-14I-14-ADAPTER MALE X 13H NUT

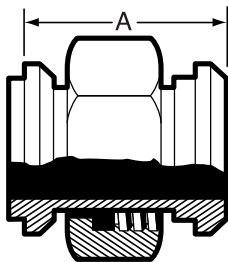

Size Tube OD	A
1	1.968
1 1/2	2.250
2	2.250
2 1/2	2.562
3	2.687
4	2.812

## E17-14I-14MP - ADAPTER MALE X CLAMP

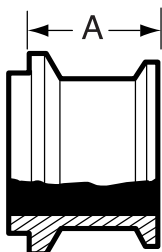

Size Tube OD	A
1	1.093
1 1/2	1.250
2	1.250
2 1/2	1.312
3	1.406
4	1.656
6	1.687

# E-LINE FITTINGS

STAINLESS STEEL FITTINGS  
PRODUCT CATALOG

## E17-14I-15 - ADAPTER MALE X ACME THREAD

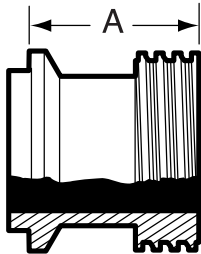

Size Tube OD	A
1	1.031
1 1/2	1.468
2	1.500
2 1/2	1.687
3	1.812
4	2.062

## E17-15I-14 - ADAPTER FEMALE X 13H NUT

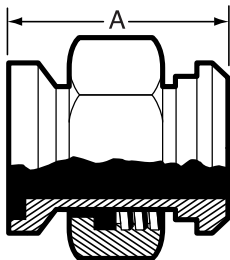

Size Tube OD	A
1	2.156
1 1/2	2.437
2	2.500
2 1/2	2.875
3	3.000
4	3.093

## E17-15I-14MP - ADAPTER FEMALE X CLAMP

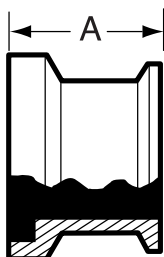

Size Tube OD	A
1	1.281
1 1/2	1.437
2	1.500
2 1/2	1.625
3	1.718
4	1.968
6	2.000

## E17-15I-15 - ADAPTER FEMALE X ACME THREAD

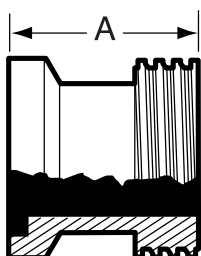

Size Tube OD	A
1	1.562
1 1/2	1.656
2	1.750
2 1/2	2.000
3	2.125
4	2.375

# E-LINE FITTINGS

STAINLESS STEEL FITTINGS  
PRODUCT CATALOG

## E211-14I - ADAPTER MALE X MNPT

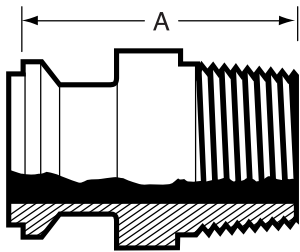

Size Tube OD	A
1	2.343
1 1/2	2.500
2	2.593
2 1/2	3.125
3	3.406
4	3.593
6	4.812

## E211-15I - ADAPTER FEMALE X MNPT

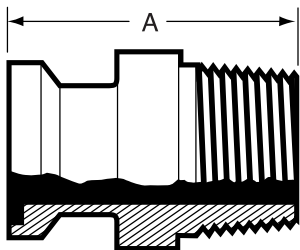

Size Tube OD	A
1	2.531
1 1/2	2.687
2	2.843
2 1/2	3.437
3	3.718
4	3.906
6	5.125

## E221-14I - ADAPTER MALE X FNPT

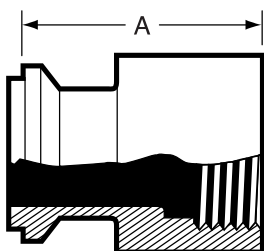

Size Tube OD	A
1	1.687
1 1/2	2.187
2	2.218
2 1/2	2.437
3	2.718
4	3.031

## E221-15I - ADAPTER FEMALE X FNPT

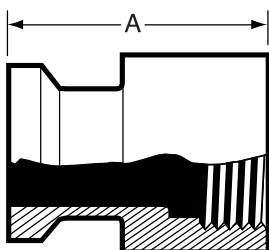

Size Tube OD	A
1	1.906
1 1/2	2.375
2	2.468
2 1/2	2.781
3	3.031
4	3.343

# E-LINE FITTINGS

## STAINLESS STEEL FITTINGS PRODUCT CATALOG

### E23BI - THERMOMETER CAP

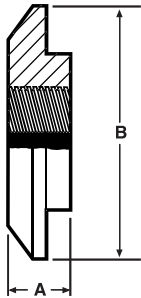

Size Tube OD	A	B
*1	0.500	2.000
1 1/2	0.500	2.000
2	0.562	2.625
2 1/2	0.750	3.312
3	0.750	3.875
4	0.750	4.875

\*STD 1/2" FNPT. All others 3/4" FNPT.

### E28AI - LATERAL ALL ENDS FEMALE

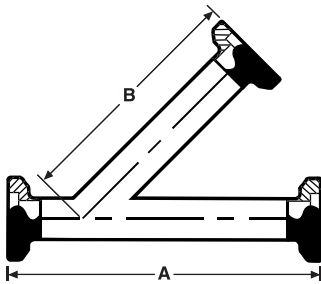

Size Tube OD	A	B
1	7.562	5.781
1 1/2	9.250	7.125
2	10.687	8.156
2 1/2	12.437	9.656
3	13.187	10.093
4	15.500	12.093
6	19.125	15.625

### E28BI - TRUE Y ALL ENDS FEMALE

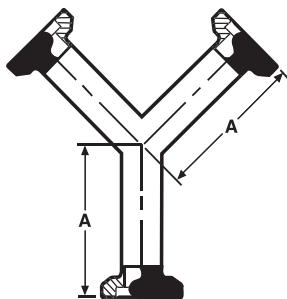

Size Tube OD	A
1	3.781
1 1/2	3.937
2	5.031
2 1/2	6.156
3	7.218
4	9.343
6	9.125

### E16AI-14I - MALE END CAP



Size Tube OD	A	B
1	2.000	0.500
1 1/2	2.000	0.500
2	2.625	0.562
2 1/2	3.312	0.750
3	3.875	0.750
4	4.875	0.750
6	7.500	0.875

# E-LINE FITTINGS

STAINLESS STEEL FITTINGS  
PRODUCT CATALOG

## E16AI-15I - FEMALE END CAP



Size Tube OD	A	B
1	2.000	0.500
1 1/2	2.000	0.500
2	2.625	0.687
2 1/2	3.312	0.750
3	3.875	0.750
4	4.875	0.750
6	7.500	0.750

## GASKETS



Gasket Materials	Part Number
Buna N	E40IH
EPDM	E40IE
Teflon	E40IT
Viton®	E40IV
Silicone	E40IS

Available in 1" to 6" sizes.

## E13IU - BOLTED CLAMP

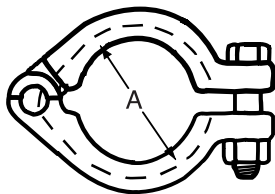

Size Tube OD	A
1	2.122
1 1/2	2.122
2	2.800
2 1/2	3.500
3	4.060
4	5.000
6	7.625

## E13IS - HEAVY DUTY CLAMP

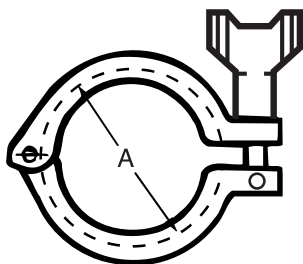

Size Tube OD	A
1	2.122
1 1/2	2.122
2	2.800
2 1/2	3.500
3	4.060
4	5.000
6	7.625

### \*PSI SERVICE RATINGS FOR SANITARY STAINLESS STEEL CLAMPS

Size Tube OD	E13IU		E13IS	
	@70°F	@250°F	@70°F	@250°F
1" & 1 1/2"	500	250	500	250
2"	450	250	450	250
2 1/2"	400	200	400	200
3"	350	150	350	150
4"	200	125	200	125
6"	150	75	150	75

\*Service ratings are based upon hydrostatic tests using Standard Molded Buna-N gasket material with proper expansion of ferrules, joint assembly, and the absence of shock pressure. All ratings systems are dependent upon related components in the system and proper installation.

### E311-14I - CONCENTRIC REDUCER MALE X MALE

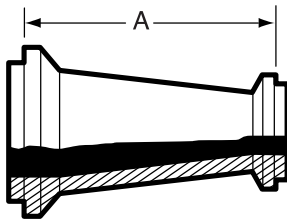

Size Tube OD	A
1 1/2 x 1	3.343
2 x 1	5.375
2 x 1 1/2	3.500
2 1/2 x 1 1/2	5.593
2 1/2 x 2	3.562
3 x 1 1/2	7.656
3 x 2	5.625
3 x 2 1/2	3.750
4 x 2	9.812
4 x 2 1/2	7.875
4 x 3	5.937
6 x 3	7.218
6 x 4	7.343

### E311-14I-15I - CONCENTRIC REDUCER MALE X FEMALE

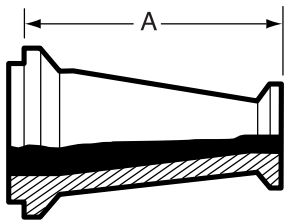

Size Tube OD	A
1 1/2 x 1	3.531
2 x 1	5.562
2 x 1 1/2	3.718
2 1/2 x 1 1/2	5.781
2 1/2 x 2	4.875
3 x 1 1/2	7.843
3 x 2	5.937
3 x 2 1/2	4.062
4 x 2	10.062
4 x 2 1/2	8.187
4 x 3	6.250
6 x 3	7.406
6 x 4	7.875

### E311-15I-14I - CONCENTRIC REDUCER FEMALE X MALE

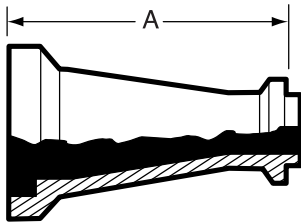

Size Tube OD	A
1 1/2 x 1	3.531
2 x 1	5.625
2 x 1 1/2	3.781
2 1/2 x 1 1/2	5.906
2 1/2 x 2	3.937
3 x 1 1/2	7.968
3 x 2	6.000
3 x 2 1/2	4.062
4 x 2	10.125
4 x 2 1/2	8.187
4 x 3	6.250
6 x 3	7.531
6 x 4	7.656

### E311-15I - CONCENTRIC REDUCER BOTH ENDS FEMALE

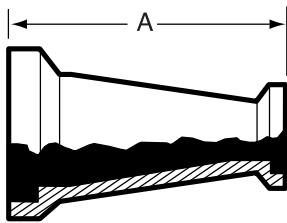

Size Tube OD	A
1 1/2 x 1	3.718
2 x 1	5.812
2 x 1 1/2	3.968
2 1/2 x 1 1/2	6.093
2 1/2 x 2	4.187
3 x 1 1/2	8.156
3 x 2	6.250
3 x 2 1/2	4.375
4 x 2	10.375
4 x 2 1/2	8.500
4 x 3	6.562
6 x 3	7.843
6 x 4	7.968

### E32I-14I - ECCENTRIC REDUCER MALE X MALE

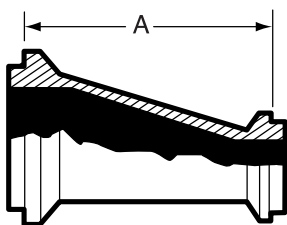

Size Tube OD	A
1 1/2 x 1	3.343
2 x 1	5.375
2 x 1 1/2	3.500
2 1/2 x 1 1/2	5.593
2 1/2 x 2	3.562
3 x 1 1/2	7.656
3 x 2	5.625
3 x 2 1/2	3.750
4 x 2	9.812
4 x 2 1/2	7.875
4 x 3	5.937
6 x 3	7.218
6 x 4	7.968



### E32I-14I-15I - ECCENTRIC REDUCER MALE X FEMALE

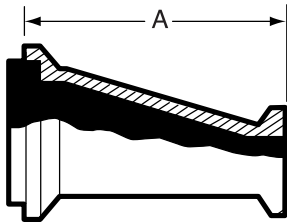

Size Tube OD	A
1 1/2 x 1	3.531
2 x 1	5.562
2 x 1 1/2	3.718
2 1/2 x 1 1/2	5.781
2 1/2 x 2	4.875
3 x 1 1/2	7.843
3 x 2	5.937
3 x 2 1/2	4.062
4 x 2	10.062
4 x 2 1/2	8.187
4 x 3	6.250
6 x 3	7.406
6 x 4	7.875

### E32I-15I-14I - ECCENTRIC REDUCER FEMALE X MALE

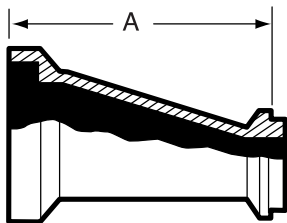

Size Tube OD	A
1 1/2 x 1	3.531
2 x 1	5.625
2 x 1 1/2	3.781
2 1/2 x 1 1/2	5.906
2 1/2 x 2	3.937
3 x 1 1/2	7.968
3 x 2	6.000
3 x 2 1/2	4.062
4 x 2	10.125
4 x 2 1/2	8.187
4 x 3	6.250
6 x 3	7.531
6 x 4	7.656

### E32I-15I - ECCENTRIC REDUCER BOTH ENDS FEMALE

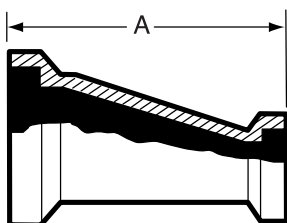

Size Tube OD	A
1 1/2 x 1	3.718
2 x 1	5.812
2 x 1 1/2	3.968
2 1/2 x 1 1/2	6.093
2 1/2 x 2	4.187
3 x 1 1/2	8.156
3 x 2	6.250
3 x 2 1/2	4.375
4 x 2	10.375
4 x 2 1/2	8.500
4 x 3	6.585
6 x 3	7.687
6 x 4	8.000

# E-LINE FITTINGS

## STAINLESS STEEL FITTINGS PRODUCT CATALOG

### SCHEDULE 5 - (T316L)

#### E14WI-5 - SHORT MALE WELDING FERRULE

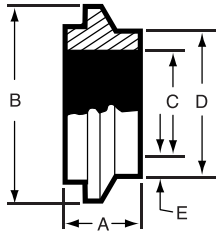

Size Pipe	A	B	C	D	E
1	0.945	2.000	1.185	1.315	0.065
1 1/2	1.024	2.648	1.770	1.900	0.065
2	1.142	3.317	2.245	2.375	0.065
2 1/2	1.220	3.868	2.709	2.875	0.083
3	1.343	4.882	3.334	3.500	0.083
4	1.343	5.882	4.334	4.500	0.083

#### E15WI-5 - SHORT FEMALE WELDING FERRULE

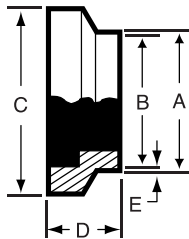

Size Pipe	A	B	C	D	E
1	1.315	1.185	2.000	0.945	0.065
1 1/2	1.900	1.770	2.648	1.024	0.065
2	2.375	2.245	3.317	1.142	0.065
2 1/2	2.875	2.709	3.868	1.220	0.083
3	3.500	3.334	4.882	1.343	0.083
4	4.500	4.334	5.882	1.343	0.083

#### E16AI-14I-5 - MALE END CAP

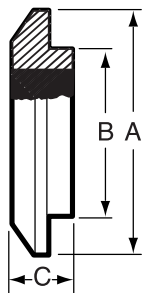

Size Pipe	A	B	C
1	2.000	1.751	0.500
1 1/2	2.648	2.244	0.585
2	3.317	2.746	0.750
2 1/2	3.868	3.307	0.750
3	4.882	4.295	0.750
4	5.882	5.295	0.750

#### E16AI-15I-5 - FEMALE END CAP

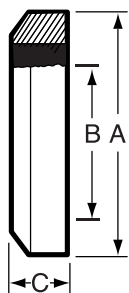

Size Pipe	A	B	C
1	2.000	1.772	0.500
1 1/2	2.684	2.264	0.687
2	3.317	2.766	0.750
2 1/2	3.868	3.327	0.750
3	4.882	4.311	0.750
4	5.882	5.311	0.750

# E-LINE FITTINGS

## STAINLESS STEEL FITTINGS PRODUCT CATALOG

### SCHEDULE 5 - (T316L)

#### E14WLI-5 - LONG MALE WELDING FERRULE

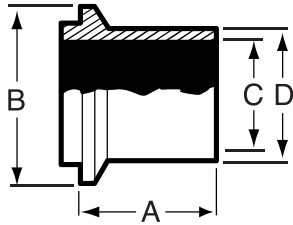

Size Pipe	A	B	C	D
1	1.562	2.000	1.185	1.315
1 1/2	1.843	2.648	1.770	1.900
2	2.062	3.317	2.245	2.375
2 1/2	1.562	3.868	2.709	2.875
3	1.562	4.882	3.334	3.500
4	1.562	5.882	4.334	4.500

#### E15WLI-5 - LONG FEMALE WELDING FERRULE

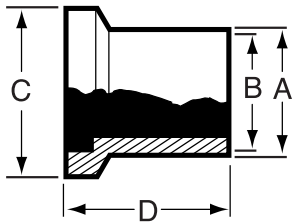

Size Pipe	A	B	C	D
1	1.315	1.185	2.000	1.750
1 1/2	1.900	1.770	2.648	2.031
2	2.375	2.245	3.317	2.312
2 1/2	2.875	2.370	3.868	2.500
3	3.500	2.870	4.882	2.687
4	4.500	3.834	5.882	3.000

#### E13IS-5 - HEAVY DUTY CLAMP - T304

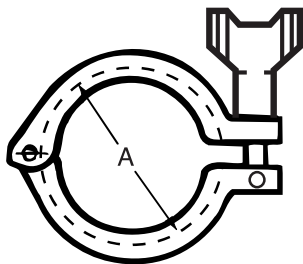

Size Pipe	A
1	2.122
1 1/2	2.800
2	3.500
2 1/2	4.060
3	5.000
4	6.130

#### E13IU-5 - CLAMP BOLTED - T304

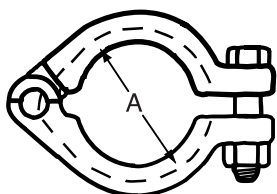

Size Pipe	A
1	2.122
1 1/2	2.800
2	3.500
2 1/2	4.060
3	5.000
4	6.130

# E-LINE FITTINGS

STAINLESS STEEL FITTINGS  
PRODUCT CATALOG

## EQ - LINE

### E14WQ-6L (T316L Material Only)

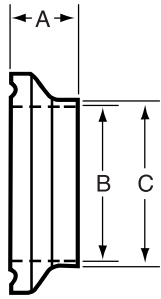

Size Tube OD	A	B	C
1	0.531	0.870	1.000
1 1/2	0.563	1.370	1.500
2	0.813	1.870	2.000
2 1/2	0.938	2.370	2.500
3	0.938	2.870	3.000
4	1.000	3.834	4.000

### E16AQ-14Q

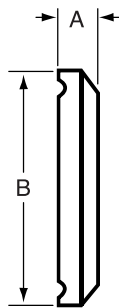

Size Tube OD	A	B
1	0.313	2.000
1 1/2	0.313	2.000
2	0.438	2.648
2 1/2	0.500	3.313
3	0.500	3.870
4	0.625	4.870