

Building connections that last™



Series 8170 & Series 8171

Brass Ball Valves, Threaded
& Sweat Datasheet



Brass Ball Valve, Threaded Series 8170



Design Features

- 600 lb. WOG, 150 lb. WSP
- Full port
- Forged brass body
- Blow-out proof stem
- Chrome plated ball
- UL Listed (1/4" - 2") Threaded
- FM Approved, (1/2" - 2")
- CSA Approved under z21.15a for 1/2 psig (1/2" - 2") - Threaded
- CSA Approved under 3-88 for 5 psig (1/2" - 2") - Threaded
- Approved under ANSI/ASM B16.33 spec for gas piping to 125 psig (1/2" - 2")
- Meets Fed Spec WW-V-35, Type II, Class A, Style 3 (1/2" - 2")
- Conforms to MSS-SP110
- Certified to NSF/ANSI 61.8
- ISO 9001:2008 manufacturer

Note: Product contains brass which does not meet federal and state requirements for drinking water.

Parts & Materials

No.	Part	Material
1	Nut	Forged Steel ASTM - AISI-1010 (1/8" - 2") - ASTM A-283 (2-1/2" - 4")
2	Handle	Forged Steel ASTM-A-283-D
3	Packing Nut	Brass ASTM B-16, C36000 (1/8" - 2") - ASTM B-124, C37700 (2-1/2" - 4")
4	Stem Packing	PTFE
5	Stem	Brass ASTM B-16, C36000 (1/8" - 2") - ASTM B-124, C37700 (2-1/2" - 4")
6	Body	Forged Brass ASTM B-124 C37700, (1/8" - 1 1/2") - Cast Brass ASTM B-584 C85700, (2" - 4")
7	Ball Seat	PTFE
8	Ball	Chrome Plated, Brass ASTM B-16, C36000, (1/8" - 1/2") Chrome Plated, Forged Brass ASTM B-124, C37700 (3/4" - 4")
9	Body End Cap	Forged Brass ASTM B-124, C37700

Dimensions

Size	Part Number	Weight	A	B	C	D	Cv
In		Lb	In	In	In	In	
1/8	01728170A	0.34	1.81	1.37	0.37	3.23	6.5
1/4	01728170C	0.34	1.81	1.37	0.37	3.23	6.5
3/8	01728170E	0.34	1.81	1.37	0.37	3.23	6.5
1/2	01728170G	0.42	2.12	1.45	0.50	3.23	10.0
3/4	01728170I	0.83	2.41	1.78	0.75	3.94	26.0
1	01728170K	1.25	2.96	2.29	0.98	4.72	48.0
1-1/4	01728170L	2.05	3.28	2.44	1.24	4.72	70.0
1-1/2	01728170M	2.80	3.62	3.0	1.50	7.09	105.0
2	01728170N	4.72	4.21	3.30	1.98	7.09	200.0
2-1/2	01728170P	7.89	5.15	3.85	2.48	7.87	380
3	01728170Q	11.7	5.90	4.17	2.95	7.87	550
4	01728170T	16.0	7.38	6.00	3.85	10.5	1050

WARNING: Cancer and Reproductive Harm - www.P65Warnings.ca.gov

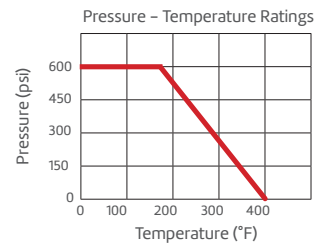
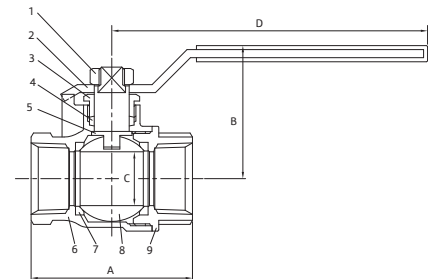

Brass Ball Valve, Sweat Series 8171

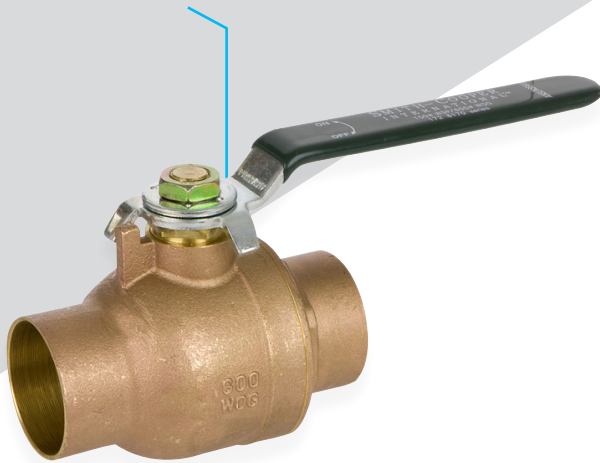

Design Features

- 600 lb. WOG, 150 lb. WSP
- Full port
- Forged brass body
- Blow-out proof stem
- Chrome plated ball
- Meets Fed Spec WW-V-35, Type II, Class A, Style 3 (1/2" – 2")
- Conforms to MSS-SP110
- Certified to NSF/ANSI 61.8
- ISO 9001:2008 manufacturer

Note: Product contains brass which does not meet federal and state requirements for drinking water.

WARNING: Cancer and Reproductive Harm – www.P65Warnings.ca.gov

Parts & Materials

No.	Part	Material
1	Nut	Forged Steel ASTM – AISI-1010 (1/8"-2") – ASTM A-283 (2-1/2"- 4")
2	Handle	Forged Steel ASTM-A-283-D
3	Packing Nut	Brass ASTM B-16, C36000 (1/8"-2") – ASTM B-124, C37700 (2-1/2"- 4")
4	Stem Packing	PTFE
5	Stem	Brass ASTM B-16, C36000 (1/8"-2") – ASTM B-124, C37700 (2-1/2"- 4")
6	Body	Forged Brass ASTM B-124 C37700, (1/8"- 1 1/2") – Cast Brass ASTM B-584 C85700, (2" – 4")
7	Ball Seat	PTFE
8	Ball	Chrome Plated, Brass ASTM B-16, C36000, (1/8"- 1/2") – Chrome Plated, Forged Brass ASTM B-124, C37700 (3/4"- 4")
9	Body End Cap	Forged Brass ASTM B-124, C37700

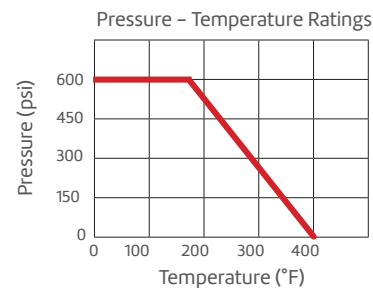
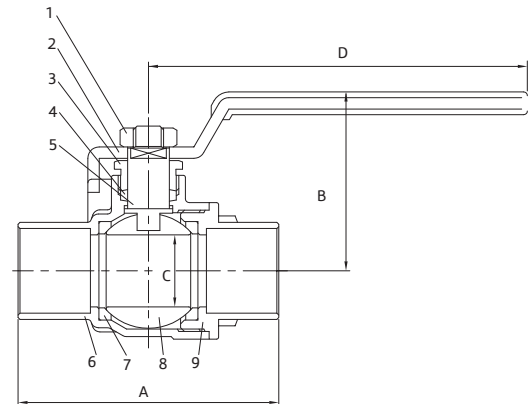

Dimensions

Size	Part Number	Weight	A	B	C	D	Cv
In		Lb	In	In	In	In	
1/2	01728171G	0.37	1.94	1.45	0.50	3.23	10
3/4	01728171I	0.79	2.73	1.88	0.75	3.94	26
1	01728171K	1.16	3.29	2.29	0.98	4.72	48
1-1/4	01728171L	1.88	3.74	2.44	1.24	4.75	70
1-1/2	01728171M	2.57	4.30	3.0	1.50	7.09	105
2	01728171N	4.53	5.31	3.30	1.98	7.09	200
2-1/2	01728171P	6.88	6.34	4.17	2.55	7.87	380
3	01728171Q	11.24	7.17	4.96	2.95	9.84	550
4	01728171T	15.69	9.21	5.62	3.94	9.84	1050

About ASC Engineered Solutions

ASC Engineered Solutions is defined by quality—in its products, services and support. With more than 1,400 employees, the company's portfolio of precision-engineered piping support, valves and connections provides products to more than 4,000 customers across industries, such as mechanical, industrial, fire protection, oil and gas, and commercial and residential construction. Its portfolio of leading brands includes ABZ Valve®, AFCON®, Anvil®, Anvil EPS, Anvil Services, Basic-PSA, Beck®, Catawissa, Cooplet®, FlexHead®, FPPI®, Gruklok®, J.B. Smith, Merit®, North Alabama Pipe, Quadrant®, SCI®, Sharpe®, SlideLOK®, SPF® and SprinkFLEX®. With headquarters in Commerce, CA, and Exeter, NH, ASC also has ISO 9001:2015 certified production facilities in PA, TN, IL, TX, AL, LA, KS, and RI.



asc-es.com

Building connections that last™

